

SitaPipe PP

Many variations. Quick to install.



- + For main and emergency drainage
- + UV stability - suitable for internal and external use
- + 3-layer composite system - dimensional stability and more impact-resistant
- + Sleeve connections, pipes and formed parts suitable for overpressures up to 1.5 bar - equivalent to a water column of 15 m
- + The economical connecting pipe system made of polypropylene - easy installation



SitaPipe PP
pipe



SitaPipe PP
bend



SitaPipe PP
cleaning pipe



SitaPipe PP
blank 45°



SitaPipe PP
blank 87,3°



SitaPipe PP
double plug-in coupler



SitaPipe PP
transition piece
eccentric



SitaPipe PP
long coupler 70



SitaPipe PP
slide-over coupler 70



SitaPipe PP
pipe clamp



SitaPipe PP
base plate



SitaPipe PP
threaded rod/pipe

SitaPipe PP

Product features at a glance:

Product features

Applications	To reroute rainwater from the Sita outlet to the sewers or onto surfaces that can be freely and safely flooded
Material	Polypropylene Galvanised steel
Temperature resistance, min.	-10 °C
Material class	Euroclass E / B1 low flammability Euroclass A1 /A1 non-flammable
Properties	<ul style="list-style-type: none">+ White internal surfaces to simplify video inspections+ Mechanical resistance, very high mechanical strength, even against impacts up to -10°C+ System resistant to underpressures up to - 400 mbar and overpressures up to 1.5 bar+ Good acoustic comfort: 16 dB(A) in accordance with EN 14366 and 18 dB(A) in accordance with DIN 4109 at a flow rate of 2 l/s+ Ecological because it is made of fully recyclable material+ Can be connected to other materials such as SitaPipe stainless steel, PE, PVC and PP
Workmanship	The general rules of engineering as well as the installation examples and installation instructions of Sita Bauelemente GmbH form the basis. The installation examples are for illustration purposes only and are a general, non-binding recommendation. The design is shown in schematic form only and does not replace the necessary work, detail and installation planning by the contractor. The customer, planner, contractor, etc. is responsible for checking the suitability, completeness and dimensions for the project and adjusting or tailoring the components to suit local requirements. Neighbouring works are shown in schematic form with no guarantee of their being complete or correct. The technical specifications in the information sheets, workmanship guidelines and system permits must be adhered to.

SitaPipe PP pipe



Tender text

SitaPipe PP pipe, made of polypropylene, to DIN EN 1451-1 as a plug-in pipe system with EPDM lip seal fitted in the socket at the factory, sharp end with a phase for simplified insertion in the socket, supply and install to professional standards.

Technical drawing



Size DN	OD*	a (mm)	Article number
70	75	500	60 00 75 05
		1000	60 00 75 10
		2000	60 00 75 20
100	110	500	60 00 11 05
		1000	60 00 11 10
		2000	60 00 11 20
125	125	500	60 00 12 05
		1000	60 00 12 10
		2000	60 00 12 20
150	160	500	60 00 16 05
		1000	60 00 16 10
		2000	60 00 16 20

* OD = Outer diameter (mm)

SitaPipe PP bend



Tender text

SitaPipe PP bend, made of polypropylene, to DIN EN 1451-1 as a plug-in pipe system with EPDM lip seal fitted in the socket at the factory, sharp end with a phase for simplified insertion in the socket, supply and install to professional standards.

Technical drawing

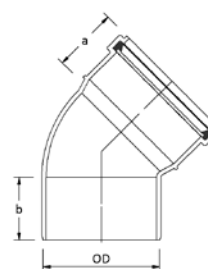

Size DN	OD*	Bend	a (mm)	b (mm)	Article number
70	75	15°	52	53	60 04 15 75
		30°			60 04 30 75
		45°			60 04 45 75
		87,3°			60 04 88 75
100	110	15°	59	61	60 04 15 11
		30°			60 04 30 11
		45°			60 04 45 11
		87,3°	61		60 04 88 11
125	125	15°	64	66	60 04 15 12
		30°			60 04 30 12
		45°			60 04 45 12
		87,3°	59		60 04 88 12
150	160	15°	79	83	60 04 15 16
		30°		75	60 04 30 16
		45°			60 04 45 16
		87,3°			60 04 88 16

* OD = Outer diameter (mm)

SitaPipe PP cleaning pipe



Tender text

SitaPipe PP cleaning pipe, made of polypropylene, to DIN EN 1451-1 as a plug-in pipe system with EPDM lip seal fitted in the socket at the factory, sharp end with a phase for simplified insertion in the socket, supply and install to professional standards.

Technical drawing

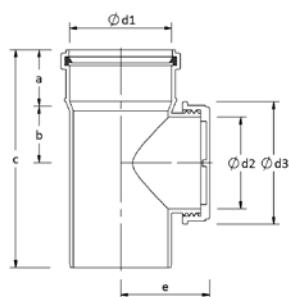

Size DN	OD*	a (mm)	b (mm)	c (mm)	e (mm)	d1 (mm)	d2 (mm)	d3 (mm)	Article number
70	75	52	43	188	75	75	62	90	60 08 75 10
100	110	59	65	238	102	110	90	119	60 08 11 11
125	125	65	74	267	109	125	112	150	60 08 11 12
150	160	79	67	291	127	160	113	148	60 08 11 13

* OD = Outer diameter (mm)

SitaPipe PP blanch 45°



Tender text

SitaPipe PP branch 45°, made of polypropylene, to DIN EN 1451-1 as a plug-in pipe system with EPDM lip seal fitted in the socket at the factory, sharp end with a phase for simplified insertion in the socket, supply and install to professional standards.

Technical drawing

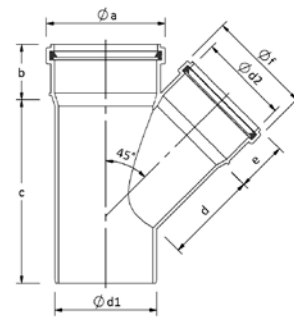

Size DN	OD	a (mm)	b (mm)	c (mm)	d (mm)	e (mm)	f (mm)	d1 (mm)	d2 (mm)	Article number
70	75	90	52	166	81	52	90	75	75	60 05 75 75
100	110	128	59	172	80			110		60 05 11 75
				219	111	59	128	110	60 05 11 11	
125	125	146	64	229	116	64	146	125	125	60 05 11 12
				247	129					125
150	160	185	79	250	126	59	128	160	110	60 05 11 16
				259	132	65	146		125	60 05 12 16
				308	158	79	185		160	60 05 16 16

SitaPipe PP blanch 87,3°



Tender text

SitaPipe PP branch 87.3°, made of polypropylene, to DIN EN 1451-1 as a plug-in pipe system with EPDM lip seal fitted in the socket at the factory, sharp end with a phase for simplified insertion in the socket, supply and install to professional standards.

Technical drawing

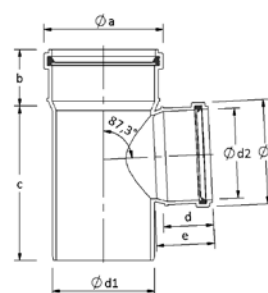

Size DN	OD	a (mm)	b (mm)	c (mm)	d (mm)	e (mm)	f (mm)	d1 (mm)	d2 (mm)	Article number
70	75	90	52	138	52	62	90	75	75	60 06 75 75
				147		66				
100	110	128	59	180	59	79	128	110	110	60 06 11 11
				193		71				

SitaPipe PP

double plug-in coupler



Tender text

SitaPipe PP double plug-in coupler, made of polypropylene, to DIN EN 1451-1 as a plug-in pipe system with EPDM lip seals fitted in the sockets at the factory, holds two pipe ends, supply and install to professional standards.

Technical drawing

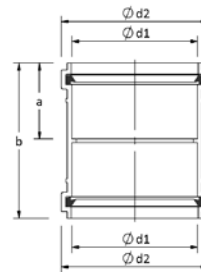

Size DN	OD*	a (mm)	b (mm)	d1 (mm)	d2 (mm)	Article number
70	75	59	120	75	90	60 09 75 75
100	110	67	136	110	128	60 09 11 11
125	125	71	144	125	145	60 09 12 12
150	160	86	176	160	185	60 09 16 16

* OD = Outer diameter (mm)

SitaPipe PP

transition piece eccentric



Tender text

SitaPipe PP transition piece eccentric, made of polypropylene, to DIN EN 1451-1 as a plug-in pipe system with EPDM lip seal fitted in the socket at the factory, sharp end with a phase for simplified insertion in the socket, supply and install to professional standards.

Technical drawing

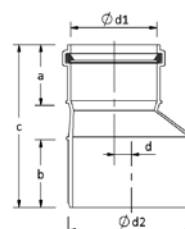

Size DN	OD*	a (mm)	b (mm)	c (mm)	d (mm)	d1 (mm)	d2 (mm)	Article number
70	75	55	59	142	15	75	110	60 01 11 75
100	110	59	66	129	4	110	125	60 01 12 11
		60	83	106	10		160	60 01 11 16
125	125			105	4	125		60 01 12 16

* OD = Outer diameter (mm)

SitaPipe PP long coupler



Tender text

SitaPipe PP long coupler, made of polypropylene, to DIN EN 1451-1 as a plug-in pipe system with EPDM lip seal fitted in the coupler at the factory, holds one pipe end, supply and install to professional standards.

Technical drawing

Size DN	OD*	a (mm)	b (mm)	c (mm)	d (mm)	Article number
70	75	180	121	89	75	60 07 00 75
100	110	207	133	127	110	60 07 00 11
125	125	222	140	136	125	60 07 00 12

* OD = Outer diameter (mm)

SitaPipe PP

slide-over coupler



Tender text

SitaPipe PP slide-over coupler, made of polypropylene, to DIN EN 1451-1 as a plug-in pipe system with EPDM lip seals fitted in the couplers at the factory, holds two pipe ends, without central rib, supply and install to professional standards.

Technical drawing

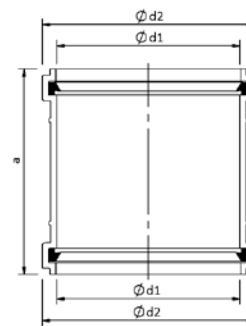

Size DN	OD*	a (mm)	d1 (mm)	d2 (mm)	Article number
70	75	120	75	90	60 03 00 75
100	110	136	110	128	60 03 00 11
125	125	147	125	145	60 03 00 12
150	160	180	160	185	60 03 00 16

* OD = Outer diameter (mm)

SitaPipe PP Pipe clamp



Tender text

SitaPipe PP pipe clamp made of galvanised steel, with EPDM insert and M10 or G1/2" threaded connection for fastening on structure, supply and install to professional standards.

Technical drawing

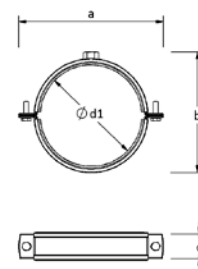

Size DN	OD*	Execution	a (mm)	b (mm)	c (mm)	d1 (mm)	Article number
70	75	M10	127	97	30	75	64 20 00 75
100	110		161	133		110	64 20 00 11
125	125		177	148		125	64 20 00 12
150	160		225	183		160	64 20 00 16
70	75	1/2"	127	107		75	64 30 00 75
100	110		161	142		110	64 30 00 11
125	125		177	157		125	64 30 00 12
150	160		225	192		160	64 30 00 16

* OD = Outer diameter (mm)

SitaPipe PP Base plate



Tender text

SitaPipe PP base plate made of galvanised steel, with M10 or 1/2" threaded connection for fastening on structure combined with the SitaPipe PP threaded pipe or threaded rod, supply and install to professional standards.

Technical drawing

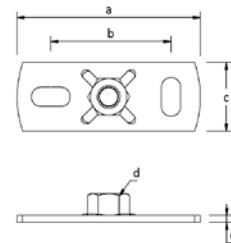

a (mm)	b (mm)	c (mm)	d	e (mm)	Article number
80	53	30	M10	3	65 00 00 00
120	80	40	1/2"		65 00 00 10

SitaPipe PP threaded rod/pipe



Tender text

SitaPipe PP threaded rod/threaded pipe, made of galvanised steel, with M10 or 1/2" thread for fastening on structure combined with the SitaPipe PP base plate, supply and install to professional standards.

Execution	Length (mm)	Article number
M10	1000	65 00 10 00
1/2"	2000	65 00 10 10

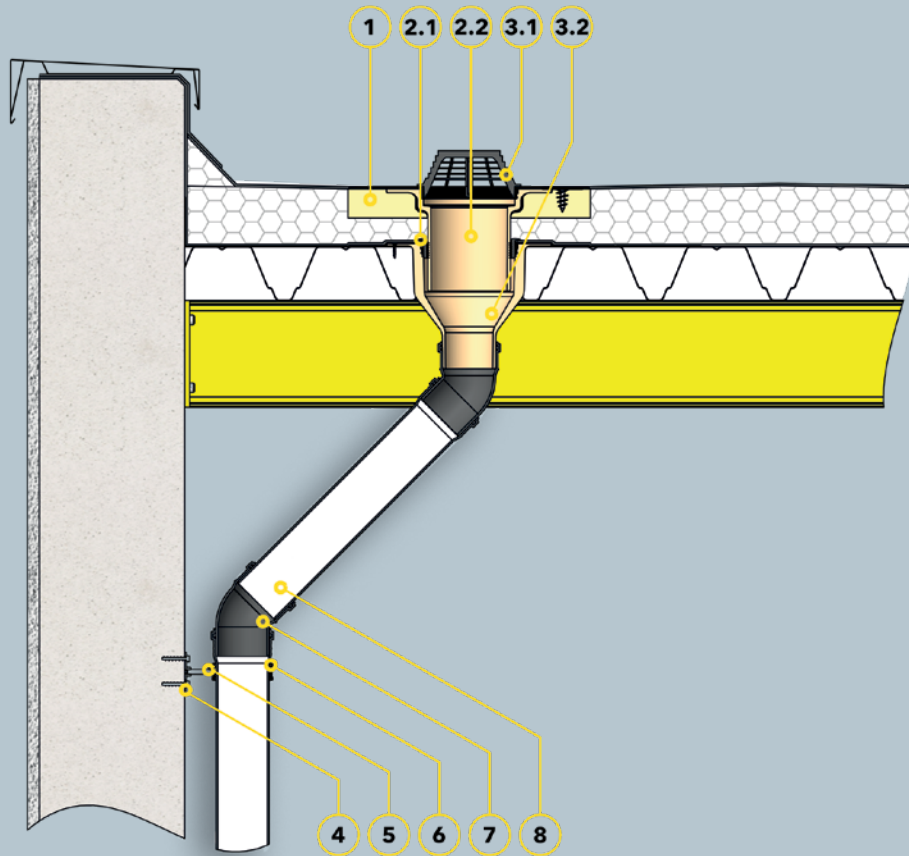

Components

1 SitaStandard insulating body for extension unit

SitaStandard extension unit, consisting of:

2.1 Sealing ring

2.2 Base body

SitaStandard, vertical, consisting of:

3.1 Dome grate

3.2 Base body

4 SitaPipe PP base plate

5 SitaPipe PP threaded rod

6 SitaPipe PP pipe clamp

7 SitaPipe PP bend 45°

8 SitaPipe PP pipe

Roof structure

Non-ventilated roof structure to the general rules of engineering with:

+ Waterproof membrane

+ Thermal insulation

+ Vapour barrier

+ Substructure